

# Dual Flush Valve Instruction

## Installation Layout

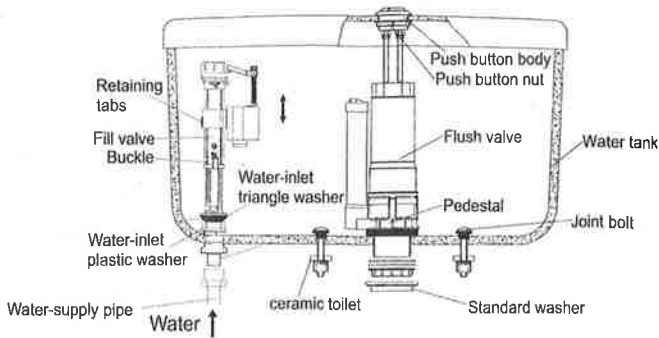

1. Please read carefully the following installation instructions. In order to avoid injuring body or damaging equipment, please install the equipment following the instructions step by step.
2. The instructions are compiled according to the up-to-date product information. We reserve the rights to make the changes about specifications, packaging and supplying without prior notice.
3. When valve installed, the critical level mark on fill valve (identified by a CL mark on valve body) should be at least 1" (=25.4mm) above top of overflow pipe. This is a plumbing code.
4. We shall not be responsible for any failure of using any parts from other companies.
5. Water temperature: 2°C-45°C.

## I 、 Fill Valve Installation

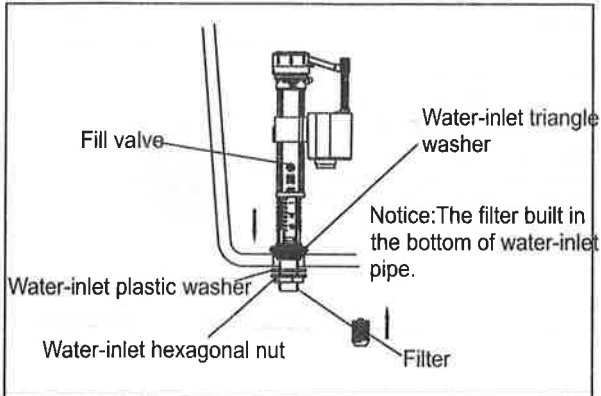

Put fill valve & water-inlet triangle washer insert into water-inlet hole of water tank, then, cover water-inlet flat washer, plastic washer and hexagonal nut in turn from the bottom of fill valve. Fastening water-inlet hexagonal nut and make a proper adjust according to the size of water tank.

## II 、 Water level adjustment

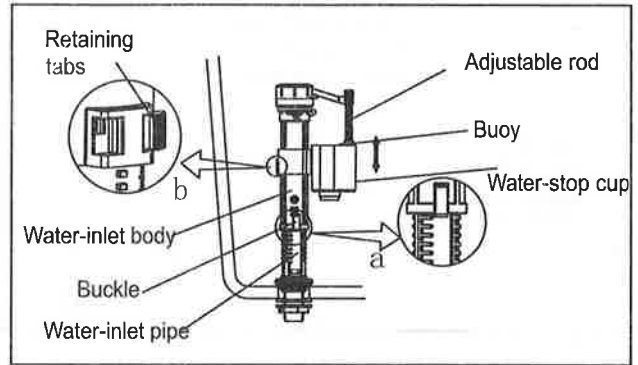

Adjust water level: 1. Fetch out Located clip and screw off water-inlet body anti-clockwise (Figure a), pull upside or press downside to the proper situation, then, screwing on water-inlet body closely and install the buckle.

2. Adjust the retaining tabs (as shown in Figure b), fixed snap right out, Will be adjusted to the desired location seal cup, and then adjust the lever will be transferred to and floats Sealing cup flat. Retaining tabs to the left then into the back by a fixed state.

Little adjustment on water lever: Revolve adjustable rod to adjust the height of water-stop cup and buoy to reach the suitable water level you need.

## III、 Water supply pipe installation

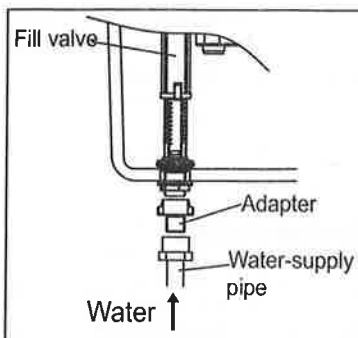

Connect water -supply pipe and built in adapter or filter according to your actual need.

#### IV 、 Flush Valve Installation (According to the actual need)

##### 1.Stainless steel hook for one-piece flush valve installation

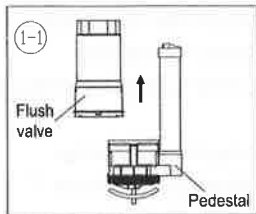

Circumrotate drainage body and make it remove from pedestal.Circumrotate stainless steel hook to the end of bolt.

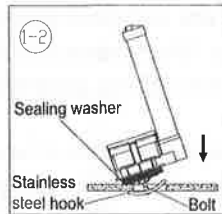

Let pedestal aim at the water tank scupper,deflect properly, circumrotate,and, the stainless steel hook can reach the scupper downside,then,revise the pedestal,the sealing washer should put upside. Go through the pedestal by the middle finger of left hand to keep off stainless steel hook and make its both sides put around the outfall symmetrically.

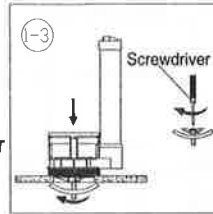

Circumrotate bolt byscrewdriver and be sure that seal between sealing washer and the surrounding for outfall.

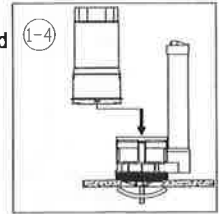

Install flush valve.

##### 2.Two-piece flush valve installation

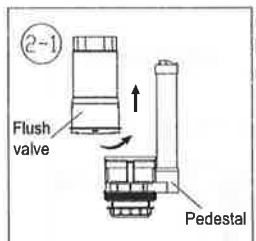

Circumrotate drainage body and make it remove from pedestal.

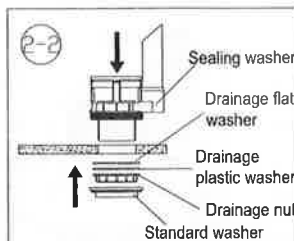

Let pedestal insert into outfall from inside of warter tank, cover the sealing washer, drainage plastic washer,then, circumrotate drainage nut and cover the standard washer, and it can adjust the put angle properly according to the actual size of water tank.

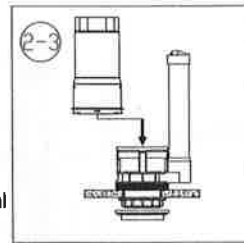

Install flush valve.

#### V 、 Push-button Installation

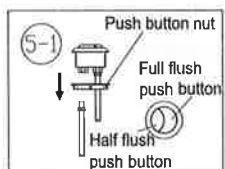

Screw off push button nut.

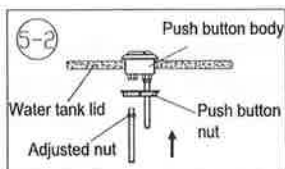

Let push button insert into water tank lid middle hole,screwing on push button nut from the bottom of water tank lid,then,screwing sure that it is firm.

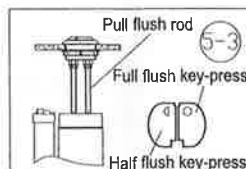

Please confirm pull flush rod press the flush valve key-press whether or not and check it is blocked or not.

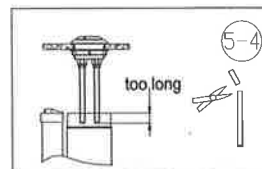

Screw off pull flush rod, the cut part is upside.

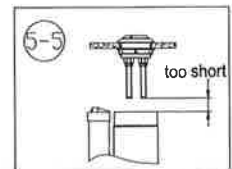

Pull flush rod should aim at the full flush key-press.

Notice: If the products is different from the photo shown, please refer to the actual product.